

ECO II+ AMALGAM SEPARATOR



ECO II AND ECO II+
REPLACEMENT

PureWay Compliance, Inc.

2716 Ocean Park Blvd, Suite 3080
Santa Monica, California 90405

M-F 8-5 CST 877.765.3030 • www.PureWay.com



ECO II+ AMALGAM SEPARATOR

Index

SECTION	PAGE
Index	2
ECO II+ Replacement Kit Components	3
Replacing ECO II Legacy with ECO II+	4
Replacing ECO II+ with ECO II+	8
Disposal of the full collection container	10
ECO Facts	11
Contact Us	11
ECO II+ Application and Explanation of Components	11
Logbook	13
Notes	14

Recycling Facility

MRI Inc.
2530 Kirby Cir NE, Ste 301/302
Palm Bay, FL, 32905

ECO II+ Replacement Kit Components

The ECO II+ Amalgam Separator requires minor assembly before being ready to install to a dental vacuum system. Follow the instructions below to assemble and install your ECO II+.

STEP 1

Remove all contents from the ECO II+ kit. Each system comes with the following components.

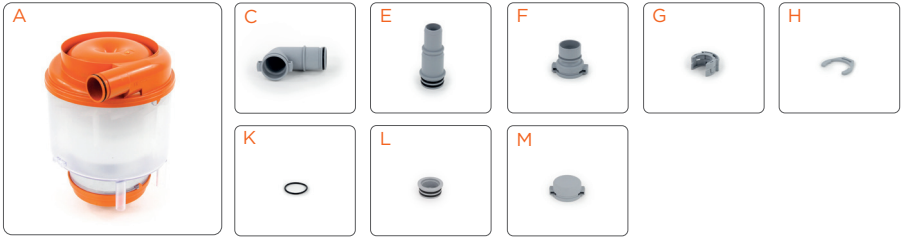

- A 1x ECO II+ Canister filtration system (orange top, clear cylinder)
- C 1x outlet elbow 90° with o-ring
- E 2x connector 20/25 with o-rings
- F 2x adaptor ECO II+
- G 2x secure clamp
- H 3x clip ECO II+
- K 2x black o-rings 28x2
- L 2x sealing plug ECO II Legacy
- M 2x sealing cap ECO II+

Type Place Placement information

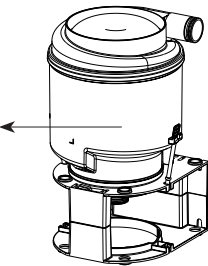
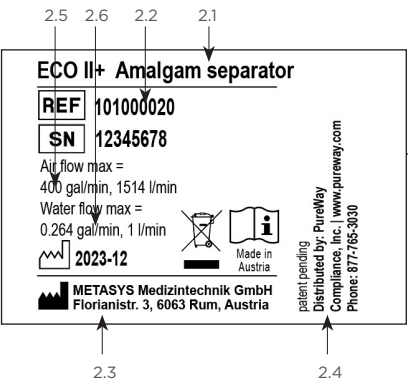

The type plate is located directly on the front side of the amalgam separator.

- 2.1 Equipment type
- 2.2 Serial number
- 2.3 Manufacturer's address
- 2.4 Distributor's address
- 2.5 Max. suction volume
- 2.6 Max. water flow rate

Replacing ECO II Legacy with ECO II+

ECO II Legacy TO ECO II+



ECO II



ECO II+



Before replacing the canisters, turn off water for 10 minutes to allow the system to drain. Wear protective gloves and face mask! Avoid contact with the contents of the amalgam separator! It is not possible to open the ECO II+ and reuse it! Every attempt to open the amalgam separator results in the malfunction of the device. Moreover, the required separation rate will no longer be achieved!

If the system you have has O-rings, please leave them on to assist in sealing in the liquids and creating an air tight seal.

STEP 1

OUTLET

Remove the secure clamp, remove the adapter with the tube and tightly close the waste water outlet with the sealing plug, E.

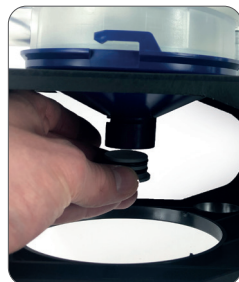
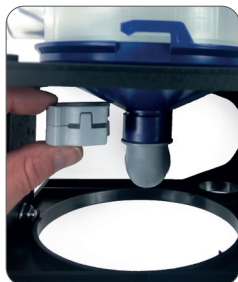

STEP 2

Unscrew stainless-steel cylinders.

Remove the screws from the stainless-steel cylinders completely from the foundation brackets.

The cylinders are no longer needed for the ECO II+.

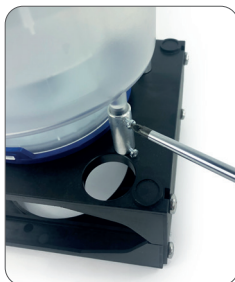

STEP 3

INLET

Remove the secure clamp and remove the adapter with the tube.

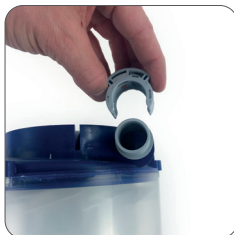

STEP 4

Remove the full amalgam separator and position it in a tilted, steady position. Make sure that the inlet opening is facing upwards!

Pour **0.67 fl. oz. or 20 ml of a cleaning agent** suitable for dental evacuation systems into the inlet opening of the full amalgam separator. Then close the water inlet with the sealing plug, **M**. LEAVE the O-rings intact, a new set is provided with the replacement kit.

For Disposal see page 11: **“Disposal of the full collection container”**



STEP 5

Fit the O-rings, **K** onto the ECO II+, **A** "OUTLET" and "INLET" openings as shown.



STEP 6

Put the fitting elements, **C** and **F** onto the ECO II+ Canister and secure them with the clip, **H**.

The elbow **C** should fit securely up against the ECO II+ orange discharge spout.

OUTLET



STEP 7

Place the new ECO II+ canister onto the foundation bracket. The ECO II+ canister must be placed on top of the foundation bracket; the black prongs will fit securely into the clear canister cylinders to create support.



STEP 8

Put the fitting element, **F**, onto the ECO II+ Canister and secure them with the clip, **H**.

Connect the ECO II+ with the adapter which was used with the ECO II and secure it with the secure clamp, **G**.

Then connect the tube onto the adapter.

If reusing the Legacy foundation bracket, the tension rods are not utilized, the back cylinders are elongated for support.

INLET



STEP 9

Connect the ECO II+ with the adapter which was used with the ECO II and secure it with the secure clamp, **G**.

Then connect the tube onto the adapter.

OUTLET



Before replacing the canisters, turn off water for 10 minutes to allow the system to drain. Wear protective gloves and face mask! Avoid contact with the contents of the amalgam separator! It is not possible to open the ECO II+ and reuse it! Every attempt to open the amalgam separator results in the malfunction of the device. Moreover, the required separation rate will no longer be achieved!

If the system you have has O-rings, please leave them on to assist in sealing in the liquids and creating an air tight seal.

Replacing ECO II+ with ECO II+

ECO II+ TO ECO II+



ECO II+



ECO II+



Wear protective gloves and face mask! Avoid contact with the contents of the amalgam separator!

It is not possible to open the ECO II+ and reuse it! Every attempt to open the amalgam separator results in the malfunction of the device. Moreover, the required separation rate will no longer be achieved!

STEP 1

Remove the adapter with the tube at the waste water inlet and waste water outlet.

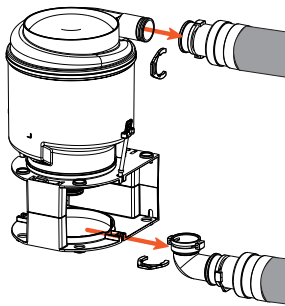

STEP 2

Tightly close the outlet of the full ECO II+ with the sealing cap, **N** and fix it with the clip, **H**.

Leave the o-rings on the ECOII+ to create an air-tight seal when the cap is used. A new set of o-rings is provided with the replacement kit.

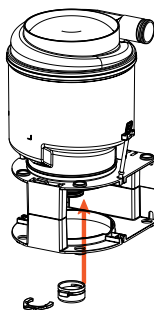

STEP 3

Detach the tension parts 3.1 from the ECO II+ canister and take out the full amalgam separator by lifting it off upwards.

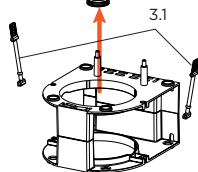

STEP 4

Position the full amalgam separator in a tilted, steady position. Make sure that the inlet opening is pointing upwards!

Pour 0.67 fl. oz. or 20 ml of a cleaning agent suitable for dental evacuation systems into the inlet opening of the full amalgam separator.

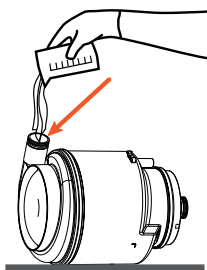

STEP 5

Afterwards also tightly close the inlet opening with the sealing cap, **N** and fix it with the clip, **H**.

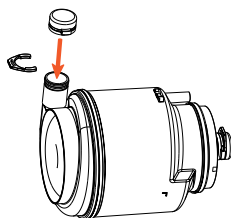

For Disposal see page 11: **“Disposal of the full collection container”**

STEP 6

Install the new amalgam separator and secure it with the tension parts.

Tension rods add support but the prongs on the back of the foundation bracket have been elongated to add and secure the ECO system in place.

Silver cylinder sleeves cannot be reused for this model.

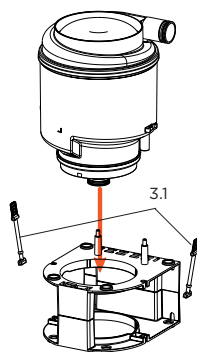

STEP 7

Reconnect the adapter with the tube to the “IN” and “OUT” openings.

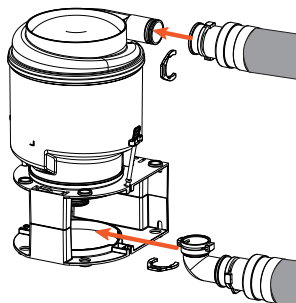

Check inlet and outlet of the ECO II+ for tightness!

Suck in a large quantity of water (at least 0.5 gal or 2 l) to check the system for leakages. If leakages are found, check the hose connections.

Disposal of the full canister

For technical and hygienic reasons the canister is designed for single use. The reuse of a used container can lead to malfunction and violates the warranty regulations!



Wear protective gloves and face mask!

Avoid contact with the contents of the canister!

Recycling packaging steps

STEP 1

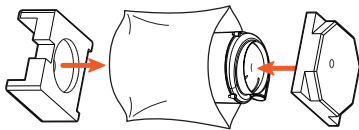

Place the properly sealed amalgam separator into the plastic liner and then into the two styrofoam shells.

STEP 2

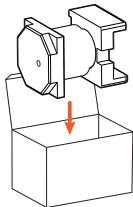

Place the amalgam separator and the styrofoam shells into the box and close it.

STEP 3

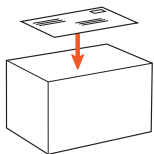

The prepaid return shipping label is located under the top lid, peel off and place label on top of the box. If you cannot locate a label, click on **www.pureway.com/shipping-assistance** to request a free label for disposal. Once shipping label is secured to top outside of the box you are now ready to return your system. Give to your UPS carrier, use UPS drop off or click on **www.pureway.com/shipping-assistance** to schedule a pickup.

The recycling of the full amalgam separator will be handled by a certified mercury recycling facility.

The prepaid return label ships directly to a certified recycling facility, certificate of destruction will be made out to and mailed to the business name and address on the label. To sign up for e-certificates or paperless maintenance logbook download our free PureWay iPhone and Android application.

To access your e-certificates online via e-mail, please visit www.PureWay.com (create an account). For assistance contact **support@pureway.com** subject line Portal Assistance, we strive to return messages within 24 hours.

Certificates of Destruction will be mailed out upon disposal from the certified mercury recycling facility, please expect 2-3 weeks for mail delivery.

To request replacement shipping labels, visit **www.PureWay.com** or, email: **support@pureway.com** subject line: shipping label request.

For installation and replacement videos, visit www.pureway.com/ecoi-amalgam-separator If you would like to reorder, or need assistance call 877-765-3030 M-F 8-5 CST for Live assistance.

ECO Facts

The ECO canister should always maintain water inside the canister.

Placement should work with the flow of gravity not against it.

The ECO can be placed on the floor, supported by the black foundation bracket.

The ECO should not be hung higher than 1 foot above the wet vacuum or the drain line, this will assist in maintaining optimal flow.

PureWay provides connectors and adaptors for the assembly of ECOII + which are provided in each kit.

Utilizing cleaning solutions properly is fundamentally important in prolonging the life of the ECOII +.

Dental offices are required to follow ADA's BMP's for the maintenance and disposal of the system.

Contact Us

PureWay Compliance, Inc.

www.PureWay.com
M-F 8-5 CST 877.765.3030

ECO II+ Application and Explanation of Components

From there the waste water is led through the first large sedimentation chamber **3.2**. Afterwards it is led through the first sedimentation cartridge **3.3**, through cascades **3.4** and the second sedimentation cartridge **3.5** into the second sedimentation chamber **3.6**. Through the third sedimentation cartridge **3.7** the cleaned water is led directly into the sewage pipe **3.8**.

There are several installation options for dry vacuum and wet ring systems, please see Installation options for ECO II+ in this manual.

From there the waste water is led through the first large sedimentation chamber **3.2**. Afterwards it is led through the first sedimentation cartridge **3.3**, through cascades **3.4** and the second sedimentation cartridge **3.5** into the second sedimentation chamber **3.6**. Through the third sedimentation cartridge **3.7** the cleaned water is led directly into the sewage pipe **3.8**.

There are several installation options for dry vacuum and wet ring systems, please see Installation options for ECO II+ in this manual.

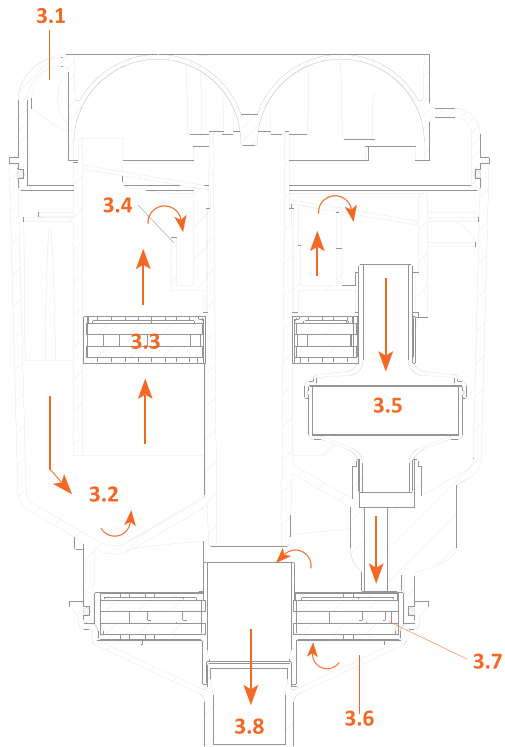

Technical Data

Low pressure range	50mbar - 300mbar
Separation rate	> 99% in accordance with ISO 11143
Canister volume	0.4 gal (1.5 liters), 4.5 lb (ca. 2 kg), > 0.18 gal (700 ml) amalgam waste
Max. ambient temperature	104° F
Possible vacuum systems	wet or dry
Max. airflow rate	400 gal/min, 1,514 l/min
Max. water flow rate	0.264 gal/min, 1 l/min
Dimensions (HxWxD)	12.2 x 7.7 x 8.4 in (309 x196 x 213 mm)
Exchange interval	approx 12 months

Equipment Log Book

- To be filled in by the technician, or the person maintaining the separator
- Service and maintenance must be carried out as per the instructions for the installation, operation and maintenance

YEAR:

MONTH 1

Name of the person
who inspected:

Date of Inspection: ____ - ____ - ____

Was the system operating properly? ☐ Yes ☐ No

Was the system needing to be replaced? ☐ Yes ☐ No

MONTH 3

Name of the person
who inspected:

Date of Inspection: ____ - ____ - ____

Was the system operating properly? ☐ Yes ☐ No

Was the system needing to be replaced? ☐ Yes ☐ No

MONTH 5

Name of the person
who inspected:

Date of Inspection: ____ - ____ - ____

Was the system operating properly? ☐ Yes ☐ No

Was the system needing to be replaced? ☐ Yes ☐ No

MONTH 7

Name of the person
who inspected:

Date of Inspection: ____ - ____ - ____

Was the system operating properly? ☐ Yes ☐ No

Was the system needing to be replaced? ☐ Yes ☐ No

MONTH 9

Name of the person
who inspected:

Date of Inspection: ____ - ____ - ____

Was the system operating properly? ☐ Yes ☐ No

Was the system needing to be replaced? ☐ Yes ☐ No

MONTH 11

Name of the person
who inspected:

Date of Inspection: ____ - ____ - ____

Was the system operating properly? ☐ Yes ☐ No

Was the system needing to be replaced? ☐ Yes ☐ No

MONTH 2

Name of the person
who inspected:

Date of Inspection: ____ - ____ - ____

Was the system operating properly? ☐ Yes ☐ No

Was the system needing to be replaced? ☐ Yes ☐ No

MONTH 4

Name of the person
who inspected:

Date of Inspection: ____ - ____ - ____

Was the system operating properly? ☐ Yes ☐ No

Was the system needing to be replaced? ☐ Yes ☐ No

MONTH 6

Name of the person
who inspected:

Date of Inspection: ____ - ____ - ____

Was the system operating properly? ☐ Yes ☐ No

Was the system needing to be replaced? ☐ Yes ☐ No

MONTH 8

Name of the person
who inspected:

Date of Inspection: ____ - ____ - ____

Was the system operating properly? ☐ Yes ☐ No

Was the system needing to be replaced? ☐ Yes ☐ No

MONTH 10

Name of the person
who inspected:

Date of Inspection: ____ - ____ - ____

Was the system operating properly? ☐ Yes ☐ No

Was the system needing to be replaced? ☐ Yes ☐ No

MONTH 12

Name of the person
who inspected:

Date of Inspection: ____ - ____ - ____

Was the system operating properly? ☐ Yes ☐ No

Was the system needing to be replaced? ☐ Yes ☐ No



Recycling Facility

MRI Inc.
2530 Kirby Cir NE, Ste 301/302
Palm Bay, FL, 32905